



2024

DATTAGURU MECHANICAL WORKS



Gala no: 05 Nana marne industries, Pokharan road 1, Thane west ,Maharashtra India,
Contact details -9022511810/9022028450 /8007988899

Email : dattaguru.mechanical0903@gmail.com

GSTIN no : 27CZBPP6496H1ZS

We provide flexible end to end solutions that assist companies to meet their objectives by giving the best possible services by our company. We provide services on time through which the other company meets their goals in the corporate industry.

We are a professionally managed organization with thorough experienced work force and well equipped facilities to ensure that we can provide quality products to our customers consistently and at competitive prices. We take pride in our technological advancements and our innovative team who is always striving to achieve greater standards by maintaining consistent quality and ensuring total customer satisfaction. Has introduced latest technology to achieve maximum production volume in minimum time at competitive cost. Due to our technology, quality & other value added advantages we assure to present the best quality product in a competitive cost. This is a must and necessary to achieve success in any sector/industry.



VISION

To become a trusted leader in manufacturing cold forged fasteners and precision components by adhering to the best quality, delivery and operations practices for ensuring customer satisfaction

MISSION

We shall grow aggressively, driven by our commitment to provide customer satisfaction and ensure long term competitive advantage to them. We will follow the best personnel practices through combined dedication, innovation and integrity thereby continuously improving our company standard.

QUALITY OBJECTIVES

We aim to provide complete customer satisfaction through timely delivery of quality products and services at competitive price in an eco-friendly, healthy and safe environment. All our products are manufactured using top quality raw materials with consistent composition. All possible measures at all stages are taken to ensure that we provide the best quality to our customers.

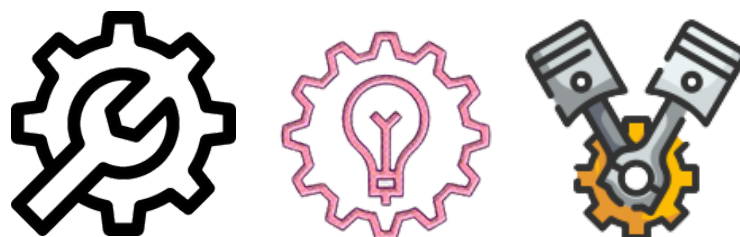



MANUAL TORQUE WRENCH

A manual torque wrench is a hand tool used to apply specific torque values to fasteners or bolts accurately. Manual torque wrenches are widely used in industries such as automotive, aerospace, manufacturing, construction, and maintenance.

IMPACT SOCKETS

able and strong sockets designed to withstand high torque and sudden rotational forces produced by impact tools. Impact sockets are used with impact wrenches to tighten or loosen fasteners in automotive, construction, and industrial applications.



IMPACT HEX BIT SOCKETS

Impact hex bit sockets are robust tools designed for use with impact drivers, offering durability and efficiency when tightening or loosening hexagonal fasteners in automotive, construction, and industrial applications.

MANUAL TORQUE WRENCH



Manual torque wrenches find extensive use in various industries, including automotive, aerospace, construction, and manufacturing. In automotive assembly, they ensure proper tightening of bolts in engines and chassis components. Aerospace relies on precise torque application for aircraft assembly. Construction utilizes torque wrenches for structural integrity, while manufacturing relies on them for consistent and controlled fastening in diverse production processes, ensuring product quality and safety.

MODEL NO.		TORQUE RANGE				SQUARE DRIVE	OVERALL LENGTH	UNIT WEIGHT
Non-Ratcheting	Ratcheting	Nm	Kgf.m	Lbf.in	Lb.ft	inches	mm	Kgs.
TVT-100A	TVTR-100A	2.5 -11	0.3 -1.1	20-100	2-8	3/8	320/360	0.65
TVT-300A	TVTR-300A	5-35	0.5-3.5	40-300	4-25	3/8	430/465	0.85
TVT-600A	TVTR-600A	12-68	1.2-7	100-600	10-50	1/2	485/530	1.5
TVT-1200A	TVTR-1200A	25-135	3-14	200-1200	20-100	1/2	545/595	2.0
TVT-2000A	TVTR-2000A	50-225	5-23	400-2000	40-160	1/2	610/660	3.0
TVT-3000A	TVTR-3000A	70-330	7-35	600-3000	50-250	1/2	835/890	4.0
TVT-5000A	TVTR-5000A	140-560	14-57	1200-5000	100-410	3/4	1120/1195	7.0
TVT-7200A	TVTR-7200A	200-800	22-80	-	150-600	3/4"	1210/1295	9.0
TVT8400A	TVTR-8400A	480-940	49-95	4200-8400	350-700	1	1400/1485	12.0
NT-14	NT-14/R	135-540	14-56	-	100-400	3/4	1120/1195	6.5
NT-14S	NT-14SR	135-780	14-78	-	100-500	3/4	1110/1195	7.0
NT-49	NT-49/R	475-1050	49-105	-	350-750	3/4	1390/1480	15.0
NT-55	NT-55/R	540-1380	55-140	-	400-1000	1	1305/1340	18.0
NT-105	NT-105/R	1000-1900	105-195	-	750-1400	1	1305/1340	18.0
NT-170	NT-170/R	1350-2700	135-275	-	1000-2000	1	1450/1530	23.5

IMPACT SOCKETS

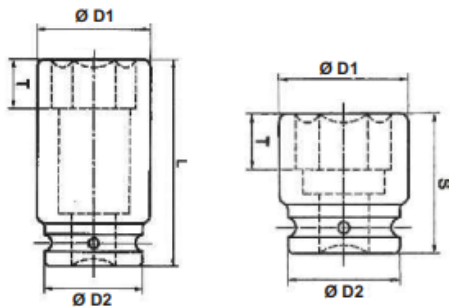

1/4" square drive

SAE SIZE		METRIC SIZE		D1	D2	S	L	T
Part No.	A/F	Part No.	A/F					
TI-114	1/4"	TIM-106	6	12	17	25	50	10
TI-115	9/32"	TIM-107	7	13	17	25	50	10
TI-116	5/16"	TIM-108	8	14.5	17	25	50	10
TI-117	11/32"	TIM-109	9	16	17	25	50	10
TI-118	3/8"	TIM-110	10	16.5	17	25	50	10
TI-119	7/16"	TIM-111	11	17.5	17	25	50	12
-	-	TIM-112	12	19	17	25	50	12
TI-120	1/2"	TIM-113	13	19.5	17	25	50	12
TI-121	9/16"	TIM-114	14	21	17	28	50	13

3/8" square drive

SAE SIZE		METRIC SIZE		D1	D2	S	L	T
Part No.	A/F	Part No.	A/F					
TI-216	5/16"	TIM-208	8	14	21	30	60	10
TI-218	3/8"	TIM-210	10	16.5	21	30	60	10
TI-219	7/16"	TIM-211	11	18	21	30	60	12
-	-	TIM-212	12	19	21	30	60	12
TI-220	1/2"	TIM-213	13	20	21	30	60	12
TI-221	9/16"	TIM-214	14	22	22	30	60	13
-	-	TIM-215	15	23	22	32	60	15
TI-223	5/8"	TIM-216	16	25	22	32	60	15
TI-224	11/16"	TIM-217	17	26	25	32	60	15
-	-	TIM-218	18	27	25	32	60	16
TI-225	3/4"	TIM-219	19	28.5	25	32	60	16
-	-	TIM-220	20	29	25	32	60	16
TI-227	13/16"	TIM-221	21	30	25	34	60	18
TI-228	7/8"	TIM-222	22	31	25	34	60	18

'O' RING & PIN for 1/4" Sq. Dr. Sockets

'O' Ring		Pin		Suitable for Socket Size	
I.D.	Φ D	Φ D	L	A/F	
14	3.0	3.0	14	6 to 14 (1/4" to 9/16")	

Durable and strong sockets designed to withstand high torque and sudden rotational forces produced by impact tools. Impact sockets are used with impact wrenches to tighten or loosen fasteners in automotive, construction, and industrial applications.

1/2" square drive

SAE SIZE		METRIC SIZE		D1	D2	S	L	T
Part No.	A/F	Part No.	A/F					
T-316	5/16"	TIM-308	8	16	26	38	80	10
TI-318	3/8"	TIM-310	10	17.5	26	38	80	10
TI-319	7/16"	TIM-311	11	19	26	38	80	12
-	-	TIM-312	12	20	26	38	80	12
TI-320	1/2"	TIM-313	13	22	26	38	80	12
TI-321	9/16"	TIM-314	14	23	26	38	80	13
-	-	TIM-315	15	24.5	27	38	80	14
TI-323	5/8"	TIM-316	16	26	27	38	80	14
TI-324	11/16"	TIM-317	17	27	27	38	80	14
-	-	TIM-318	18	29	30	40	80	14
TI-325	3/4"	TIM-319	19	30	30	40	80	16
-	-	TIM-320	20	32	30	40	80	16
TI-327	13/16"	TIM-321	21	33.5	30	40	80	18
TI-328	7/8"	TIM-322	22	35	30	40	80	18
-	-	TIM-323	23	36.5	30	42	80	21
TI-329	15-16"	TIM-324	24	38	36	42	80	21
TI-330	1"	-	-	41	36	42	80	21
TI-331	1.1/16"	TIM-327	27	42	36	45	80	23
TI-332	1.1/8"	-	-	46	36	45	80	23
TI-333	1.3/16"	TIM-330	30	46	36	45	80	24
TI-334	1.1/4"	TIM-332	32	48	36	46	80	26
TI-336	1.3/8"	-	-	55	36	51	80	28
TI-338	1.1/2"	-	-	56	36	53	80	30

'O' RING & PIN for 3/8" Sq. Dr. Sockets

'O' Ring		Pin		Suitable for Socket Size	
I.D.	Φ D	Φ D	L	A/F	
18	4.0	3.0	18	6 to 16 (1/4" to 9/16")	
22	4.0	3.0	22	15 to 22 (5/8" to 1")	

'O' RING & PIN for 1/2" Sq. Dr. Sockets

'O' Ring		Pin		Suitable for Socket Size	
I.D.	Φ D	Φ D	L	A/F	
22	4.0	4.0	22	8 to 17 (5/16" to 11/16)	
26	4.0	4.0	25	17 to 23 (3/4" to 7/8)	
32	4.0	4.0	30	24 to 32 (15/16" to 1.1/2)	

Impact sockets are specialized sockets designed to be used with impact wrenches or pneumatic tools. Unlike regular sockets, impact sockets are constructed to withstand the high torque and repetitive impacts generated by impact wrenches. They are made from tougher materials, such as chrome molybdenum steel, and often have a thicker wall to handle the increased stress. Impact sockets come in various sizes and configurations to accommodate different types of fasteners and applications, making them essential in automotive repair, construction, and other industries where powerful impact tools are used.

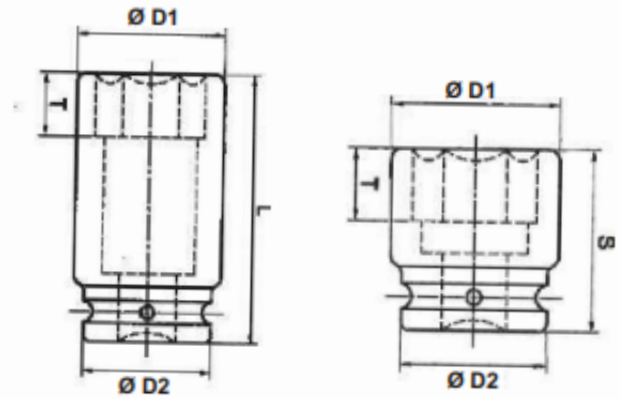

1" square drive

3/4" square drive

SAE SIZE		METRIC SIZE		D1	D2	S	L	T
Part No.	A/F	Part No.	A/F					
TI-421	9/16"	-	-	28	44	48	90	13
TI-423	5/8"	-	-	30	44	48	90	14
TI-424	11/16"	TIM-417	17	32	44	48	90	14
T-425	3/4"	TIM-419	19	34	44	48	90	16
TI-427	13/16"	-	-	36	44	50	90	16
TI-428	7/8"	TIM-422	22	38.5	44	50	90	18
TI-429	15/14"	TIM-424	24	42	44	50	90	21
TI-430	1"	-	-	43.5	44	50	90	21
TI-431	1.1/16"	TIM-427	27	44	44	50	90	23
TI-432	1.1/8"	-	-	48	44	50	90	23
TI-433	1.3/16"	TIM-430	30	48	44	50	90	24
TI-434	1.1/4"	TIM-432	32	52	44	55	90	26
TI-435	1.5/16"	-	-	53	44	55	90	26
TI-436	1.3/8"	-	-	55	44	55	90	28
TI-437	1.7/16"	TIM-436	36	55	44	60	90	28
TI-438	1.1/2"	TIM-438	38	59	44	60	90	30
TI-439	1.5/8"	TIM-441	41	66	44	66	90	36
TI-440	1.11/16"	-	-	68	44	66	100	36
TI-441	1.13/16"	TM-446	46	72	54	66	100	36
TI-442	1.7/8"	-	-	74	60	68	100	36
TI-443	1.15/16"	-	-	76	60	70	100	39
TI-444	2"	TIM-450	50	76	60	70	100	39
TI-445	2.1/16"	-	-	78	60	74	110	41
TI-446	2.3/16"	TIM-455	55	84	60	74	110	41
TI-447	2.1/4"	-	-	84	70	74	120	41
TI-448	2.3/8"	TIM-460	60	88	70	78	120	45

'O' RING & PIN for 3/4" Sq. Dr. Sockets

I.D.	'O' Ring Ø D	Pin		Suitable for Socket Size
		Ø D	L	A/F
38	5.0	5.0	35	17 to 41 (9/16" to 1.11/16")
48	5.0	5.0	45	46 (1" to 1.13/16")
54	5.0	5.0	52	50 to 55 (1.7/8" to 2.3/16")
64	5.0	5.0	62	60 (2.1/4" to 2.3/8")

SAE SIZE		METRIC SIZE		D1	D2	S	L	T
Part No.	A/F	Part No.	A/F					
TI-525	3/4"	TIM-519	19	38	54	63	110	16
TI-527	13/16"	-	-	38	54	63	110	18
TI-528	7/8"	TIM-522	22	40	54	63	110	18
T-529	15/16"	TIM-524	24	42	54	63	110	21
TI-530	1"	-	-	44	54	63	110	21
TI-531	1.1/16"	TIM-527	27	46	54	63	110	23
TI-532	1.1/8"	-	-	49	54	63	110	23
TI-533	1.3/16"	TIM-530	30	50	54	63	110	24
TI-534	1.1/4"	TIM-532	32	52	54	63	110	26
TI-535	1.5/16"	-	-	54	54	63	110	26
TI-536	1.3/8"	-	-	56	54	66	110	28
TI-537	1.7/16"	TIM-536	36	58	54	66	110	28
TI-538	1.1/2"	TIM-538	38	62	54	66	110	30
TI-538A	1.9/16"	-	-	65	54	68	110	32
TI-539	1.5/8"	TIM-541	41	67	54	68	110	36
TI-540	1.11/16"	-	-	67	54	68	110	36
TI-541	1.3/4"	-	-	72	54	74	110	36
TI-542	1.13/16"	TM-546	46	74	54	74	110	36
TI-543	1.7/8"	-	-	74	54	74	110	36
TI-544	1.15/16"	-	-	75	70	76	110	39
TI-545	2"	TIM-550	50	77	70	76	110	39
TI-546	2.1/16"	-	-	77	70	76	120	41
TI-547	2.3/16"	TIM-555	55	86	70	78	120	41
TI-548	2.1/4"	-	-	86	70	78	120	41
TI-550	2.3/8"	TIM-560	60	90	70	81	120	45
TI-551	2.7/16"	-	-	90	70	81	120	45
TI-553	2.9/16"	TIM-565	65	98	80	85	120	46
TI-554	2.5/8"	-	-	98	80	85	120	46
TI-556	2.3/4"	TIM-570	70	104	80	90	130	50
TI-557	2.13/16"	-	-	104	80	90	130	50
TI-559	2.15/16"	TIM-575	75	112	80	94	130	57
TI-560	3"	-	-	112	80	94	130	57
TI-561	3.1/8"	TIM-580	80	118	80	100	140	62
TI-563	3.3/8"	TIM-585	85	125	80	104	140	62

'O' RING & PIN for 1" Sq. Dr. Sockets

I.D.	'O' Ring Ø D	Pin		Suitable for Socket Size
		Ø D	L	A/F
48	6.0	5.0	45	19 to 46 (3/4" to 1.7/8")
64	6.0	6.0	60	50 to 60 (1.15/16" to 2.7/16")
74	6.0	6.0	70	65 to 85 (2.9/16" to 3.3/8")

1.1/2" square drive

SAE SIZE		METRIC SIZE						
Part No.	A/F	Part No.	A/F	D1	D2	S	L	T
TI-631	1.1/16"	-	-	54	86	80	130	23
TI-632	1.1/8"	-	-	58	86	80	130	23
TI-636	1.3/8"	-	-	64	86	80	130	28
TI-637	1.7/16"	TIM-636	36	64	86	80	130	28
TI-638	1.1/2"	TIM-638	38	69	86	80	130	30
TI-638/A	1.9/16"	-	-	69	86	80	130	32
TI-639	1.5/18"	TIM-641	41	69	86	83	130	36
TI-640	1.11/16"	-	-	69	86	83	130	36
TI-641	1.3/4"	-	-	69	86	83	130	36
TI-642	1.13/16"	TIM-46	46	76	86	86	130	36
TI-643	1.7/8"	-	-	76	86	86	130	36
TI-645	2"	TIM-650	50	81	86	90	130	39
TI-646	2.1/16"	-	-	81	86	90	140	41
TI-647	2.3/16"	TIM-655	55	88	86	95	140	41
TI-648	2.1/4"	-	-	88	86	95	140	41
TI-650	2.3/8"	TIM-660	60	96	86	98	140	45
TI-651	2.7/16"	-	-	96	86	98	140	45
TI-653	2.9/16"	TIM-665	65	102	86	102	140	46
TI-654	2.5/8"	-	-	102	86	102	140	46
TI-656	2.3/4"	TIM-670	70	108	86	102	150	50
TI-657	2.13/16"	-	-	108	86	102	150	50
TI-659	2.15/16"	TIM-675	75	116	86	108	150	57
TI-660	3"	-	-	116	86	108	150	57
TI-661	3.1/8"	TIM-680	80	120	86	110	150	62
TI-663	3.3/8"	TIM-685	85	130	86	115	170	62
TI-664	3.1/2"	TIM-690	90	135	125	118	170	65
TI-665	3.3/4"	TIM-695	95	140	125	123	170	70
TI-666	3.7/8"	TIM-6100	100	148	125	128	190	75
TI-668	4.1/8"	TIM-6105	105	155	125	133	190	80
TI-669	4.1/4"	-	-	155	125	133	190	80
-	-	TIM-6110	110	161	150	138	200	85
TI-670	4.1/2"	TIM-6115	115	161	150	143	200	94
TI-671	4.5/8"	TIM-6120	120	175	150	149	200	94

2.1/2" square drive

SAE SIZE		METRIC SIZE						
Part No.	A/F	Part No.	A/F	D1	D2	S	L	T
TI-750	2.3/8"	TIM-760	60	120	125	120	190	45
TI-753	2.9/16"	TIM-765	65	125	125	120	190	46
TI-756	2.3/4"	TIM-770	70	130	125	120	190	50
TI-759	2.15/16"	TIM-775	75	130	125	130	190	57
TI-761	3.1/8"	TIM-780	80	135	125	140	190	62
TI-763	3.3/8"	TIM-785	85	140	125	140	190	62
TI-764A	3.5/8"	TIM-790	90	145	125	140	190	65
TI-765	3.3/4"	TIM-795	95	155	125	150	190	70
TI-766	3.7/8"	-	-	155	125	150	190	70
TI-767	4"	TIM-7100	100	160	125	150	200	75
TI-768	4.1/8"	TIM-7105	105	165	125	160	200	80
TI-769A	4.3/8"	TIM-7110	110	174	150	160	210	85
TI-770	4.1/2"	TIM-7115	115	180	150	170	210	90
TI-771	4.5/8"	-	-	180	150	175	220	94
TI-772	4.3/4"	TIM-7120	120	185	150	175	220	94
TI-773	4.7/8"	-	-	185	150	175	220	94
TI-774	5"	-	-	195	150	175	220	98
-	-	TIM-7130	130	195	150	175	220	98
TI-775	5.3/8"	TIM-7135	135	205	150	180	220	102
TI-778	5.3/4"	TIM-7145	145	220	150	180	230	105
-	-	TIM-7150	150	230	180	190	250	110
TI-781	6.1/8"	TIM-7155	155	230	180	190	250	110
-	-	TIM-7160	160	240	180	190	-	110
TI-784	6.1/2"	TIM-7165	165	240	180	200	-	120
TI-787	6.7/8"	TIM-7175	175	255	180	200	-	120
TI-790	7.1/4"	TIM-7185	185	270	180	210	-	130
TI-793	7.5/8"	TIM-7195	195	275	180	210	-	130
TI-796	8"	TIM-7200	200	290	180	225	-	140

3.1/2" square drive

SAE SIZE		METRIC SIZE						
Part No.	A/F	Part No.	A/F	D1	D2	S	L	T
TI-871	4.5/8"	TIM-8120	120	180	175	182	277	72
TI-873	4.7/8"	TIM-8130	130	193	175	190	280	80
TI-874	5.1/4"	TIM-8135	135	197	175	198	280	83
TI-875	5.3/8"	TIM-8145	145	213	175	214	295	86
TI-877	5.5/8"	TIM-8150	150	218	175	214	295	90
TI-878	5.3/4"	TIM-8155	155	225	175	214	297	92
TI-884	6.1/2"	TIM-8165	165	237	175	231	313	98
TI-886	6.3/4"	TIM-8170	170	243	175	231	313	100
TI-888	7"	TIM-8180	180	255	175	237	320	108
TI-893	7.5/8"	TIM-8195	195	275	175	245	328	118
TI-896	8"	TIM-8200	200	280	175	250	332	120
TI-8100	8.1/2"	TIM-8215	215	298	175	263	246	125
TI-8104	9"	TIM-8230	230	317	175	279	359	132
TI-8105	9.1/8"	TIM-8235	235	325	175	279	362	136

'O' RING & PIN for 1.1/2" Sq. Dr. Sockets

'O' Ring		Pin		Suitable for Socket Size
I.D.	Φ D	Φ D	L	A/F
78	6.0	6.0	75	36 to 85 (1.1/16" to 3.3/8")
118	6.0	6.0	115	90 to 105 (3.1/2" to 4.1/4")
142	6.0	6.0	120	110 to 120 (4.1/2" to 4.5/8")

'O' RING & PIN for 2.1/2" Sq. Dr. Sockets

'O' Ring		Pin		Suitable for Socket Size
I.D.	Φ D	Φ D	L	A/F
115	10.0	10.0	115	60 to 105 (2.3/8" to 4.1/8")
140	10.0	10.0	140	110 to 145 (4.3/8" to 5.3/4")
170	10.0	10.0	170	150 to 200 (6.18" to 8")

'O' RING & PIN for 3.1/2" Sq. Dr. Sockets

'O' Ring		Pin		Suitable for Socket Size
I.D.	D	D	L	A/F
165	10.0	10.0	165	120 to 235 (4.5/8" to 9.18")

IMPACT HEX BIT SOCKETS



3/4" square drive

SAE SIZE		METRIC SIZE		Approx OAL (mm)	Hex Bit Length (mm)
Part No.	A/F	Part No.	A/F		
HI-420	1/2"	HIM-412	12	80	30
HI-421	9/16"	HIM-414	14	80	30
HI-423	5/8"	HIM-417	17	90	40
HI-425	3/4"	HIM-419	19	95	40
HI-428	7/8"	HIM-422	22	95	45
-	-	HIM-424	24	100	50

1/4" square drive

SAE SIZE		METRIC SIZE		Approx OAL (mm)	Hex Bit Length (mm)
Part No.	A/F	Part No.	A/F		
HI-110	1/8"	HIM-103	3	41	15
HI-111	5/32"	HIM-104	4	41	15
HI-112	3/16"	HIM-105	5	43	20
HI-113	7/32"	-	-	43	20
HI-114	1/4"	HIM-106	6	45	25

1" square drive

SAE SIZE		METRIC SIZE		Approx OAL (mm)	Hex Bit Length (mm)
Part No.	A/F	Part No.	A/F		
HI-518	3/8"	-	-	81	26
HI-520	1/2"	-	-	84	30
HI-521	9/16"	-	-	86	30
HI-523	5/8"	-	-	98	40
-	-	HIM-517	17	100	40
HI-525	3/4"	HIM-519	19	107	45
HI-528	7/8"	HIM-522	22	112	45
HI-529	15/16"	HIM-524	24	120	50
HI-530	1"	-	-	120	50
HI-531	1.1/16"	HIM-527	27	120	50
-	-	HIM-530	30	120	50
HI-530	1.1/8"	-	-	120	50
-	-	HIM-532	32	120	50
-	-	HIM-536	36	120	50

3/8" square drive

SAE SIZE		METRIC SIZE		Approx OAL (mm)	Hex Bit Length (mm)
Part No.	A/F	Part No.	A/F		
HI-210	1/8"	HIM-203	3	44	15
HI-211	5/32"	HIM-204	4	44	15
HI-212	3/16"	HIM-205	5	47	20
HI-213	7/32"	-	-	49	20
HI-214	1/4"	HIM-206	6	49	20
HI-216	5/16"	HIM-208	8	49	25
HI-218	3/8"	HIM-210	10	50	25

1.1/2" square drive

SAE SIZE		METRIC SIZE		Approx OAL (mm)	Hex Bit Length (mm)
Part No.	A/F	Part No.	A/F		
HI-630	1"	-	-	140	50
HI-631	1.1/16"	-	-	140	50
HI-632	1.1/8"	HIM-630	30	140	50
HI-634	1.1/4"	HIM-632	32	140	50
-	-	HIM-636	36	145	55
HI-638	1.1/2"	-	-	145	55
-	-	HIM-641	41	160	60
HIM-641	1.3/4"	-	-	170	70
-	-	HIM-646	46	170	70
HIM-645	2"	HIM-650	50	170	70

1/2" square drive

SAE SIZE		METRIC SIZE		Approx OAL (mm)	Hex Bit Length (mm)
Part No.	A/F	Part No.	A/F		
HI-314	1/4"	HIM 306	6	53	20
HI-316	5/16"	HIM 308	8	53	25
HI-318	3/8"	HIM 310	10	57	25
HI-320	1/2"	HIM 312	12	63	30
HI-321	9/16"	HIM 314	14	63	30
HI-323	5/8"	HIM 317	17	73	40